

# 6.0 X 6.75 & 9.0 X 6.75 INSERTS

## FITS 09/07 U-FRAME

Note: This insert does not include ejector plates. When ejection is required, pockets can be machined in ejector half of Molding Insert and ejector plates installed. (For Molding Inserts this size that include ejector plates see 09/07 EB Series on catalog pages 22-23.)

Standard Solid Insert (6.0 X 6.75)				
Catalog #	A	A2	B2	B
09/07 SSU 221	2.250	1.500	1.500	2.250
09/07 SSU 221S	2.250	1.500	1.500	2.250

"S" Denotes two "B" halves.

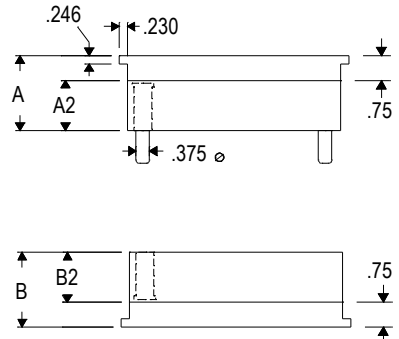
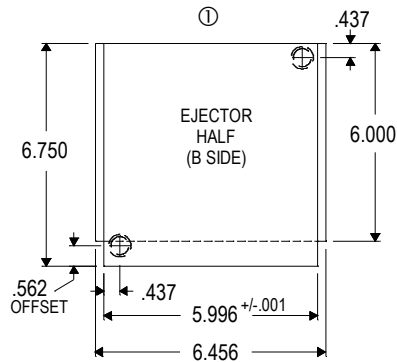

Note: This insert does not include ejector plates.

T-Style Laminated Inserts are shipped with loose ear plates				
T-Style Laminated Insert (9.0 X 6.75)				
Catalog #	A	A2	B2	B
09/07 TLU 201	2.250	1.500	1.500	2.250
09/07 TLU 201S	2.250	1.500	1.500	2.250

"S" Denotes two "B" halves.

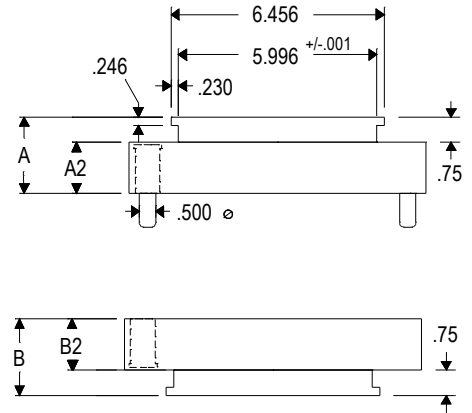
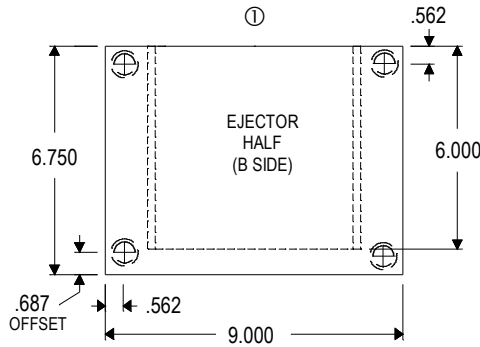

Note: This insert does not include ejector plates.

Ⓞ Clamp Side

"A" & "B" dimensions are supplied .004" to .007" oversize at parting line unless otherwise specified.